

COPYRIGHT©

Details of this drawing are the copyright of MBH Partnership and must not be reproduced or copied without prior written consent. Do not scale from this drawing.

Any errors or omissions are to be reported to the Architect immediately.

All proposed road and junction alterations subject to highways engineers detailed design.

Removal of any existing trees and landscaped areas subject negotiations with Local Authority Planning Dept. and other statutory controls.

All drawings to be read in conjunction with structural engineers drawings and all related Architects and consultant drawings and other relevant information.

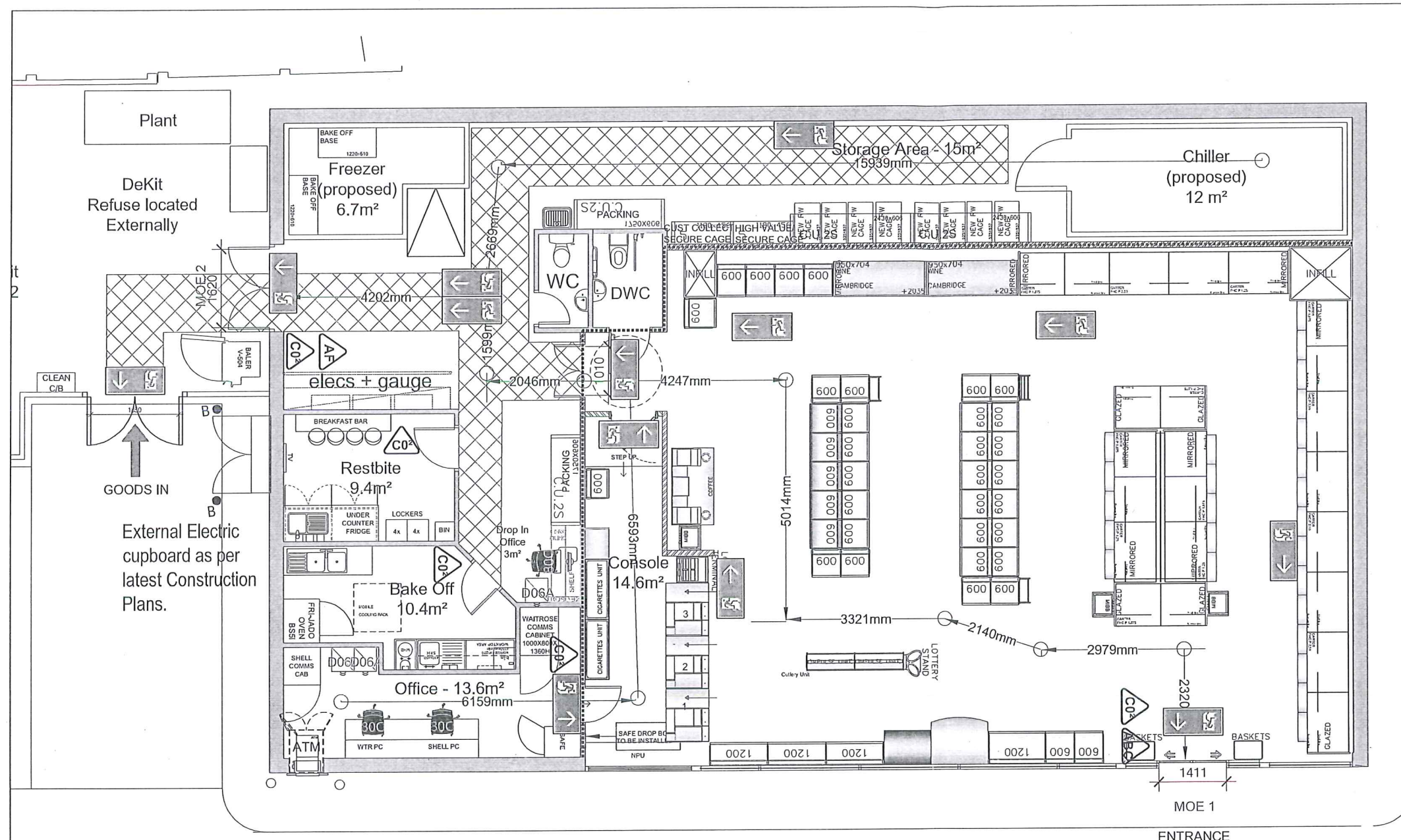

Site:	420 x 180mm, graphics inset by 10mm from edges
Material:	a) 3mm clear acrylic - wall fixing b) 5mm clear acrylic - suspended c) Ceiling fixings - 30311, 2m cable
Colours:	White on standard safety green Ceiling fixings - Sain chrome
Graphics:	As artwork
Layout:	As artwork
Fixing:	a) Wall mounted - Adhesive backed or drilled for fixing b) Suspended - Each complete with 2no s/s steel wires and necessary fixings
Sample:	

ALL FIRE ESCAPE SIGNS ON SALES FLOOR TO BE HUNG

ALL FIRE SIGNS MUST CONFORM TO BS5199:1&4 2000 A/D 5.6 & 11 2002  
THE APPROVED SUPPLIERS ARE:  
• OMEGA SIGNS  
• ASTLEY SIGNS  
SIGNS SHALL BE CONSTRUCTED OF RIGID PVC PLASTIC  
• TO BE INSTALLED AT 2.4m AFFL  
• FIRE EXIT SIGNS TO MOES MUST BE ILLUMINATED

----- 30 Min Fire rated construction  
----- 60 Min Fire rated construction

PRELIMINARY CONSTRUCTION



SCALE BAR 1:50@A1

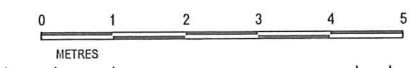

REV No.	DATE	DESCRIPTION	BY	CHKD BY

**mbh** PARTNERSHIP LLP  
ARCHITECTURE SURVEYING PROJECT MANAGEMENT

ROSEMOUNT HOUSE  
ROSEMOUNT AVENUE  
WEST BYFLEET  
SURREY  
KT14 6LD  
01932 352727  
01932 351545

PROJECT  
PROPOSED WAITROSE/SHELL FILLING STATION  
BRACKNELL  
BAGSHOT ROAD, BRACKNELL  
BERKSHIRE, RG12 0SH

DRAWING TITLE  
PROPOSED LIQUOR LICENCE PLAN

DRAWN BY MBH DS	CHECKED BY GG	DRAWING No. 11764-AD-G01	REV
SCALE 1:50 @ A1	DATE FEB 2014		

Proposed Ground Floor Plan  
SCALE 1:50@A1

OCCUPANCY LEVELS	OCCUPANCY NUMBERS= AREA/FSF
Ground Floor Sales	42 (4m²/Person)
Partners Offices/Changing Rooms	3 (6m²/Person)
Partners Dining Room	14 (1m²/Person)
Warehousing:	N/A
-Basement	N/A
-Ground Floor	3 (30m²/Person)
-First Floor	N/A
Basement Car Park/Car park	N/A
Mezzanine / Plant Areas	N/A
Unloading Area / Cage Marshalling	N/A
TOTAL	62

FLOOR SPACE FACTORS	EXIT WIDTHS = OCCUPANCY X 5mm (only applies when Occupancy > 220)
Ground Floor Sales	N/A
Partners Offices/Changing Rooms	N/A
Partners Dining Room	N/A
Warehousing:	N/A
-Basement	N/A
-Ground Floor	N/A
-First Floor	N/A
Basement Car Park/Car park	N/A
Mezzanine / Plant Areas	N/A
Unloading Area / Cage Marshalling	N/A
TOTAL	850mm for < 220 occupancy

BUILDING DESCRIPTION	AREA	SIZE (m²)
Ground Floor Sales (Gross)		165 m²
RELEVANT FLOOR AREA		166 m²
Partners Offices/Changing Rooms		13.6m²
Partners Dining Room		9.4 m²
Warehousing:		
-Basement		N/A
-Ground Floor		89 m²
-First Floor		N/A
Basement Car Park/Car park		N/A
Mezzanine / Plant Areas		External
Unloading Area / Cage Marshalling		N/A

FIRE FIGHTING EQUIPMENT	SYMBOL
AQUEOUS FILM FORMING FOAM 6 LITRE 27A-AFFF	
CO² 2KG	
FIRE BLANKET	
MULTIPURPOSE FIRE EXTINGUISHER	

**FIRE STRATEGY NOTES**

1. Means of Escape In Case of Fire (B1)  
There is 1 no. designated fire exit to the ground floor sales area customer entrance MOE1. The alternative means of escape is MOE2 at the Back of House (BOH).

The maximum height of the display units within the sales area will be 1.95 meters high. The maximum height of the storage racks in the back of house warehouse will be 2.4 meters.

Any protected escape routes will be provided with self-closing FD30S fire doors fitted with smoke seals to resist the spread of low temperature smoke. All doors on escape routes will open in the direction of escape.

Emergency lighting will be provided throughout the escape routes and necessary accommodation (i.e. windowless accommodation and lifted areas over 8m²) in accordance with the current standard of BS 5266 (Parts 1 & 7: 1999). Escape signs will be provided throughout the Waitrose Branch in accordance with BS 5499: Part 1: 2002 & BS 5449: Part 4: 2000 (which incorporates the requirements of The Health and Safety (Safety signs and signals) Regulations 1996).

2. Occupancy Figures  
BS 5588: Part 1: 1997 Code of practice for shops, offices, industrial, storage and other similar buildings recognises that in a retail environment such as this Waitrose Branch there is no single occupancy factor which covers all areas at any one time. As the Branches occupancy figures will fluctuate at different times the floor space factors will be calculated using the recommended figures.

The guidance of Approved Document B recommends 2m²/person. It is considered that it would be unreasonable to calculate the maximum numbers of people based on 2m²/person applied to the total 166m² gross sales floor area. This would result in a figure of 82 people which is unreasonable onerous occupancy density. Therefore number of customers should be calculated using 4m²/person as advised in the British Standards. This gives a total maximum occupancy within the customer area of 42 customers.

3. Exit widths  
There are 1 designated final fire exits. One located in the retail area (MOE1) which is the customer entrance/exit and the other is at the BOH. The customer entrance/exit has a clear width of 1400mm and the BOH double doors have a clear width of 1620mm, with the smallest opening being the sales floor/BOH door with a clear opening of 1910mm. Discouraging the largest exit (main customer entrance at 1400mm wide) the alternative exit has the recommended minimum clear opening of 850mm for evacuating 62 people which is the maximum occupancy. A fire assembly point will be provided. Where Partners and/or customers escape out into an enclosed service yard a suitably sized pass gate will be provided to allow full escape away from the branch.

4. Travel Distances & Final Exits  
A safe available final exit or protected route/staircase must be available within 18 metres travelling in a single direction and 45 metres where an alternative escape exit/route/staircase is available. This must be achieved from all internal rooms. In order to avoid occupants becoming trapped by fire or smoke, there should always be an alternative escape route from all parts of the building, however in the following situations a single route is acceptable:  
a. parts of a floor from which a storey exit can be reached within the travel distance limit for travel in one direction (18m), provided that no one room has an occupant capacity of 60.  
In many cases there will not be an alternative route at the beginning of the route as there may be only one exit from a room to a corridor from which point escape is possible in two directions. This is acceptable provided that the overall distance to the nearest exit is within the limits for routes where there is an alternative (45m) and the one direction only section of the route does not exceed the limit for travel where there is no alternative (18m)  
Inner rooms should not exceed an occupancy level of 60 and should be entered directly off the access room, the access room must not be a place of special fire hazard and must be fitted with a point smoke detector linked into the main fire alarm system.  
All internal/office rooms should lead directly to an escape exit without occupants having to travel through the warehouse compartment.  
All doors on MOE routes must be easily openable in one single action, without the use of a key.

5. Vertical Escape (NOT APPLICABLE FOR THIS PROJECT (BRACKNELL PFS))

6. Refuges  
Refuges are relatively safe waiting areas for short periods. They are not areas where disabled people should be left alone indefinitely until rescued by the fire brigade, or until the fire is extinguished. Whilst a refuge should be provided for each stairway they need not necessarily be located within the stair enclosure but should enable direct access to the stair. Each refuge should provide an area accessible to a wheelchair of at least 500mm x 1400mm in which a wheelchair user can await assistance. Where a refuge is a protected stairway or protected lobby or protected corridor, the wheelchair space should not reduce the width of the escape route. Where the wheelchair space is within a protected stairway, access to the wheelchair space should not obstruct the flow of person escaping. Refuges need to be clearly identified 'Refuge - Keep Clear'

7. Communication  
To facilitate the effective evacuation of people from refuges an emergency voice communication system should be provided.  
Any EVS system should comply with BS 5839 Part 9 and consist of type B outstations which communicate with a master station located in the building control room (by fire panel on entrance). Alternative approach such as the use of wireless technology (mobiles and radios) may also be used. Whatever option is used, it is essential that occupants of each refuge are able to alert other people that they are in need of assistance and for them to be reassured that this assistance will be forthcoming.

8. General  
a. Smoke detection must be in accordance with BS 5839  
b. There must be level thresholds (access and egress) to all MOE doors  
c. Automatic doors must fail safe open in the event of a power failure or fire alarm activation.  
d. All service penetrations through the wall separating the BOH and Retail areas must have adequate fire stopping.  
e. All BOH exit routes must be kept clear at all times.